

**ASHISH  
INTERNATIONAL**

*Flexible* **channel SUPPORT SYSTEM**  
for **CABLE TRAYS, HVAC**  
**Solar Modules & Pipes**  
& **INDUSTRIAL FASTENERS**

# COMPANY PROFILE



**Ashish International**  
Ashish International is renowned name in the manufacturing & export of **Flexible Channel Support System For Cable Trays & Pipes (As per BS 6946:1988) & Industrial Fasteners** components managed by the dedicated professionals having rich industrial experience with a passion for innovation and excellence. Our factory works are well equipped with the best infrastructure & latest technology to serve any sort of order to be manufactured as per required quantity. Total in house manufacturing ensures controlled quality, timely delivery & competitive prices. We vow by global work ethics & environmental friendly procedures to get the high quality finish products. We are located in the heart of Industrial Complex of Ludhiana, INDIA. with a covered area of 40000 square feet. We are engaged in the manufacturing from the last 16 years.

## Our product range includes

Flexible Channel Support System For Cable Trays & Pipes, Strut Channel, Strut Accessories, Steel Bracketry, Spring Channel Nuts, Cantilever Arms, Pipe Clamps, Foundation Bolts L & J Type, Cable Reel Threaded Rods, Fully Treaded Rods, Hex Bolts, Carriage Bolts with Oval & Square Neck, Nib Bolts, Anti Theft Bolts & Nuts, Roofing Bolts, Wedge Nuts, Coupling Nuts, Customized Products, Sheet Metal Components, & other Engg. goods

## In house facilities

Bar Drawing Machine, Channel Roll Forming, Power Presses capacity 3 Tons to 200 Tons, Hydraulic Threading & Bending Machines, Lanco Threading, Mig, Projection, Arc Welding Machines, Capstan Machine, Automatic Nut Cutting & Tapping Machines, Drill Machines, Milling Machines, Electroplating Plant, Hot Dip Galvanizing Plant, Electro Polishing Plant, Hardening & Tempering Furnance & Tool Room.

## Material Grade

Mild Steel, Stainless Steel, 4.8, 5.6 & 8.8.

## Material Finish

Zinc Plated, Hot Dip Galvanized & Electro Polished.



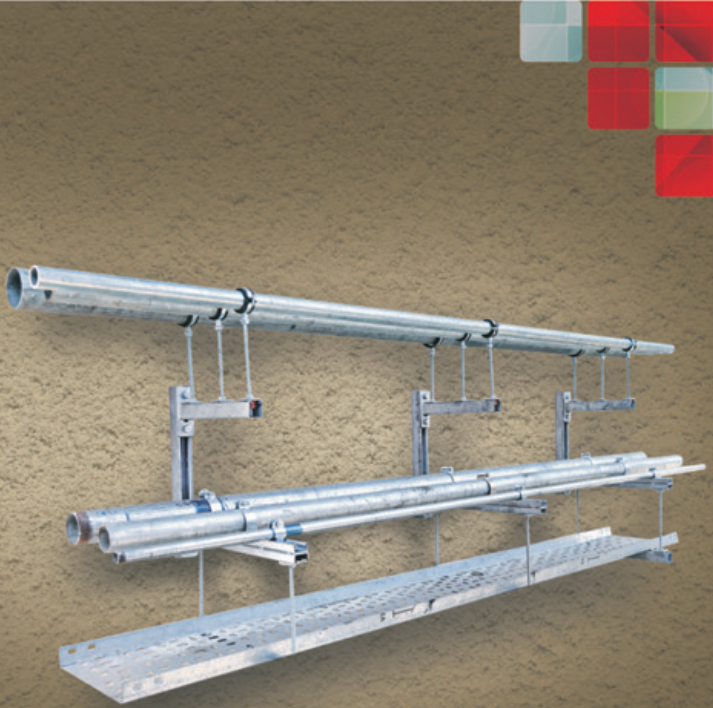

Flexible  
channel SUPPORT SYSTEM  
for **CABLE TRAYS & PIPES**

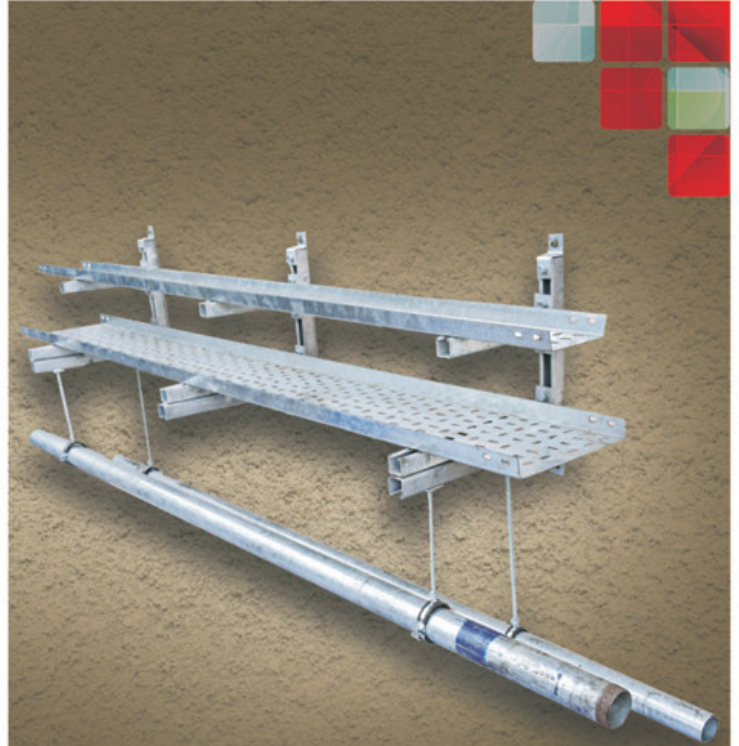

Flexible  
channel SUPPORT SYSTEM  
for **CABLE TRAYS & PIPES**



Flexible  
channel SUPPORT SYSTEM  
for **CABLE TRAYS & PIPES**



Flexible  
channel SUPPORT SYSTEM  
for **CABLE TRAYS & PIPES**



Flexible  
channel SUPPORT SYSTEM  
for **CABLE TRAYS & PIPES**

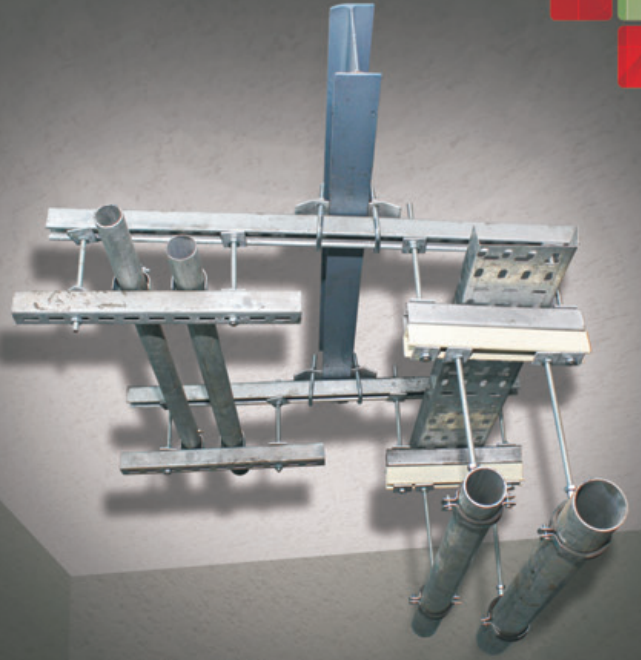

Flexible  
channel SUPPORT SYSTEM  
for **CABLE TRAYS & PIPES**



Flexible  
channel SUPPORT SYSTEM  
for **CABLE TRAYS & PIPES**



Flexible  
channel SUPPORT SYSTEM  
for **CABLE TRAYS & PIPES**



airconditioner OUTDOOR UNIT  
**MOUNTING BRACKETS**

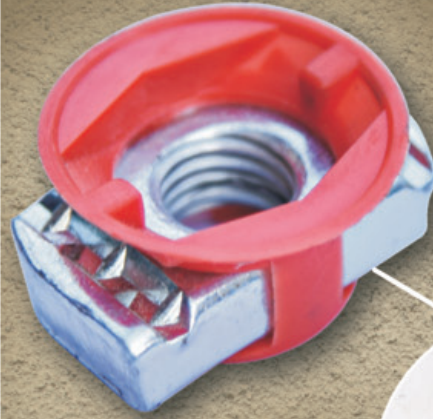

easy FIT  
**CHANNEL NUT**

CAP Design India Patent No. 251822



**MOUNTING STRUCTURE**  
for SOLAR MODULES



Industrial  
**FASTENERS**





# strut CHANNELS

## plain CHANNELS | A-41/P

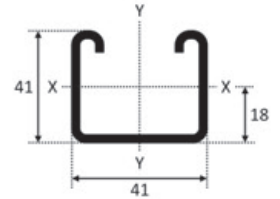
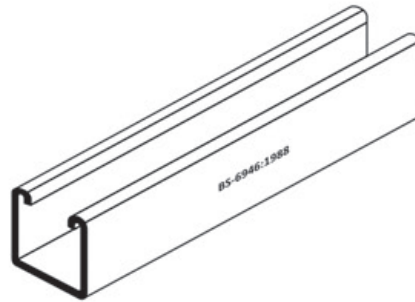

Span or Column Unsupported High (mm)	Uniform Load at 175 N/mm <sup>2</sup> Stress (kg.)	Deflection at 175 N/mm <sup>2</sup> (mm)	Uniform Load at Max. Deflection of 1/360 <sup>th</sup> Span (kg.)	Uniform Load at Max. Deflection of 1/200 <sup>th</sup> Span (kg.)	Max. Load of Column Loaded @ Slot Face (kg.)	Max. Load of Column Loaded @ Centroid (kg.)
250	1769	0.23	-	-	1693	5869
500	884	0.95	-	-	1650	5379
750	589	2.15	571	-	1554	4479
1000	442	3.82	321	-	1395	3373
1250	353	5.97	205	-	1232	2556
1500	294	8.60	142	257	1093	2020
1750	252	11.70	104	188	976	1656
2000	221	15.29	80	144	879	1395
2250	196	19.35	63	114	797	1198
2500	176	23.89	51	92	725	1044
2750	160	28.91	42	76	(663)	(919)
3000	147	34.40	35	64	(607)	(816)

## slotted CHANNELS | A-41/S

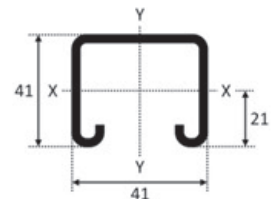
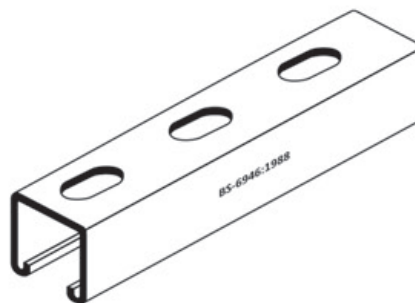

Span or Column Unsupported High (mm)	Uniform Load at 175 N/mm <sup>2</sup> Stress (kg.)	Deflection at 175 N/mm <sup>2</sup> (mm)	Uniform Load at Max. Deflection of 1/360 <sup>th</sup> Span (kg.)	Uniform Load at Max. Deflection of 1/200 <sup>th</sup> Span (kg.)	Max. Load of Column Loaded @ Slot Face (kg.)	Max. Load of Column Loaded @ Centroid (kg.)
250	1638	0.27	-	-	1660	5351
500	819	1.05	-	-	1635	5100
750	546	2.35	483	-	1557	4412
1000	409	4.18	271	-	1389	3284
1250	327	6.54	174	313	1211	2436
1500	273	2.41	120	217	1062	1899
1750	234	12.81	88	159	941	1546
2000	204	16.73	67	122	843	1297
2250	182	21.18	53	96	761	1113
2500	163	26.15	43	78	691	970
2750	148	31.64	35	64	(631)	(855)
3000	136	37.64	30	54	(578)	(761)

Series	Weight	Material Thickness	Standard Lengths		Finishes				Area of Sections	Elements of Sections Axis X-X			Elements of Sections Axis Y-Y		
	kg/m		mm	3m	6m	PL	PG	HG		SS	cm <sup>2</sup>	1cm <sup>4</sup>	Zcm <sup>3</sup>	cm	1cm <sup>4</sup>
A-41/P	2.88	2.5	●	●	●	●	●	○	3.35	7.21	3.10	1.46	9.23	4.47	1.66
A-41/S	2.73	2.5	●	●	●	●	●	○	3.00	6.10	2.87	1.42	1.42	4.44	1.74



# strut CHANNELS

## plain CHANNELS | A-21/P

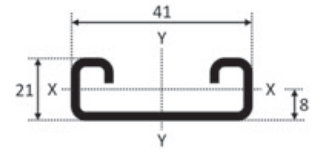
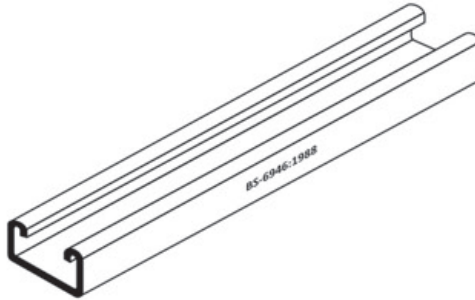

Span or Column Unsupported High (mm)	Uniform Load at 175 N/mm <sup>2</sup> Stress (kg.)	Deflection at 175 N/mm <sup>2</sup> (mm)	Uniform Load at Max. Deflection of 1/360 <sup>th</sup> Span (kg.)	Uniform Load at Max. Deflection of 1/200 <sup>th</sup> Span (kg.)	Max. Load of Column Loaded @ Slot Face (kg.)	Max. Load of Column Loaded @ Centroid (kg.)
250	553	0.45	-	-	1042	3993
500	276	1.81	212	-	995	3379
750	184	4.07	94	169	859	2198
1000	138	7.24	53	95	690	1353
1250	110	11.32	33	61	548	896
1500	92	16.30	23	42	(437)	(634)
1750	79	22.19	-	31	(353)	(471)
2000	69	28.99	-	23	-	-

## slotted CHANNELS | A-21/S

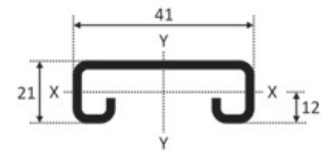
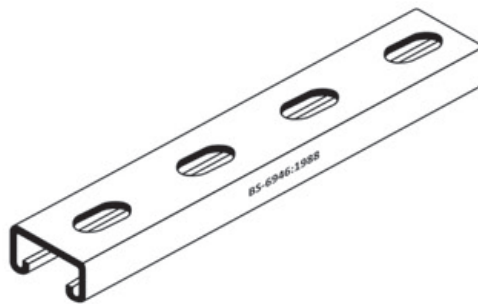
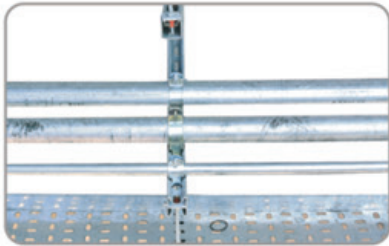

Span or Column Unsupported High (mm)	Uniform Load at 175 N/mm <sup>2</sup> Stress (kg.)	Deflection at 175 N/mm <sup>2</sup> (mm)	Uniform Load at Max. Deflection of 1/360 <sup>th</sup> Span (kg.)	Uniform Load at Max. Deflection of 1/200 <sup>th</sup> Span (kg.)	Max. Load of Column Loaded @ Slot Face (kg.)	Max. Load of Column Loaded @ Centroid (kg.)
250	508	0.50	-	-	-	-
500	254	2.01	174	-	-	-
750	169	4.54	77	139	-	-
1000	127	8.07	43	78	-	-
1250	101	12.61	27	50	-	-
1500	84	18.71	-	34	-	-
1750	72	24.73	-	25	-	-
2000	63	32.30	-	-	-	-

Series	Weight	Material Thickness	Standard Lengths		Finishes				Area of Sections cm <sup>2</sup>	Elements of Sections Axis X-X			Elements of Sections Axis Y-Y		
	kg/m	mm	3m	6m	PL	PG	HG	SS		1cm <sup>4</sup>	Zcm <sup>3</sup>	cm	1cm <sup>4</sup>	Zcm <sup>3</sup>	cm
A-21/P	1.91	2.5	●	●	●	●	●	○	2.32	1.19	0.97	0.71	5.34	2.59	1.51
A-21/S	1.76	2.5	●	●	●	●	●	○	1.97	0.98	0.89	0.70	5.29	2.56	1.63



# strut CHANNELS

## combination CHANNELS | A-41/BBP

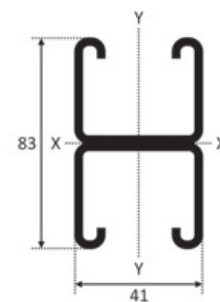
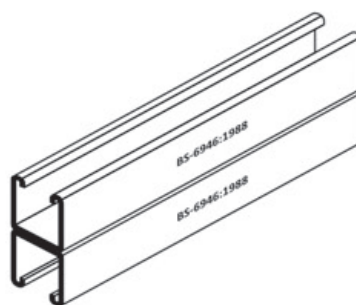

Span or Column Unsupported High (mm)	Uniform Load at 175 N/mm <sup>2</sup> Stress (kg.)	Deflection at 175 N/mm <sup>2</sup> (mm)	Uniform Load at Max. Deflection of 1/360 <sup>th</sup> Span (kg.)	Uniform Load at Max. Deflection of 1/200 <sup>th</sup> Span (kg.)	Max. Load of Column Loaded @ Slot Face (kg.)	Max. Load of Column Loaded @ Centroid (kg.)
250	-	-	-	-	2880	11952
500	-	-	-	-	2864	11682
750	1670	1.21	-	-	2833	11186
1000	1253	2.15	-	-	2783	10451
1250	1002	3.36	-	-	2695	9305
1500	835	4.84	718	-	2551	7790
1750	716	6.59	527	-	2367	6293
2000	626	8.61	404	-	2170	5068
2250	556	10.89	319	-	1977	4127
2500	501	13.45	258	465	1796	3410
2750	455	16.27	213	384	1630	2858
3000	417	19.37	179	323	(1480)	(2427)

## combination CHANNELS | A-21/BBP

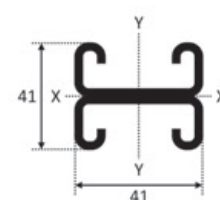
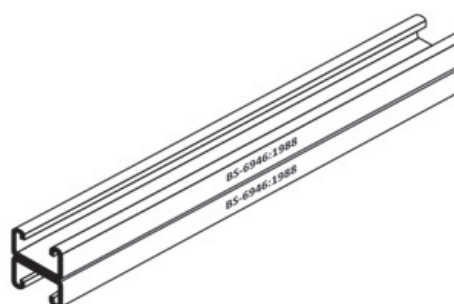
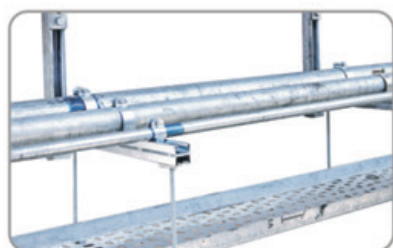

Span or Column Unsupported High (mm)	Uniform Load at 175 N/mm <sup>2</sup> Stress (kg.)	Deflection at 175 N/mm <sup>2</sup> (mm)	Uniform Load at Max. Deflection of 1/360 <sup>th</sup> Span (kg.)	Uniform Load at Max. Deflection of 1/200 <sup>th</sup> Span (kg.)	Max. Load of Column Loaded @ Slot Face (kg.)	Max. Load of Column Loaded @ Centroid (kg.)
250	1558	0.26	-	-	1834	8228
500	779	1.07	-	-	1809	7740
750	519	2.42	446	-	1756	6865
1000	389	4.30	251	-	1639	5367
1250	311	6.72	160	289	1468	3882
1500	259	9.68	111	201	1289	2838
1750	222	13.18	82	147	1123	2143
2000	194	17.21	62	113	(977)	(1668)
2250	173	21.79	49	89	(852)	(1334)
2500	155	26.90	40	72	(745)	(1090)
2750	141	32.55	33	59	(655)	(906)
3000	129	38.73	27	50	-	-

Series	Weight kg/m	Material Thickness mm	Standard Lengths		Finishes				Area of Sections cm <sup>2</sup>	Elements of Sections Axis X-X			Elements of Sections Axis Y-Y		
			3m	6m	PL	PG	HG	SS		1cm <sup>4</sup>	Zcm <sup>3</sup>	cm	1cm <sup>4</sup>	Zcm <sup>3</sup>	cm
A-41/BBP	5.77	2.5	●	●	●	○	●	○	6.70	6.27	8.78	2.32	18.46	8.94	1.66
A-21/BBP	3.76	2.5	●	●	●	○	●	○	4.64	5.64	2.73	1.10	10.68	5.18	1.51





# channel FITTINGS

## spring CHANNEL nuts

**Material :** The Channel Nuts are cold pressed, tapped so that their teeth will provide a 'BITING' action into the in turned edges of channel sections. The nut bodies are designed with beveled end which lock into position by contact with interior side walls of channel when turned at 90°.

- The channel nuts are also available in SS304 & SS316 grades in bright finish.
- Finishes available : Zinc Plated | Yellow Passivation | Hot Dip Galvanized

Case hardened Channel Nuts are also available.

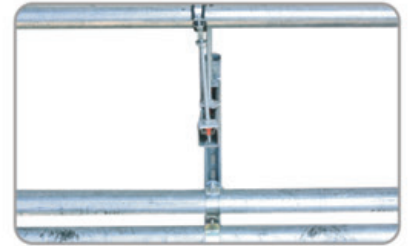

## NO spring CHANNEL nuts

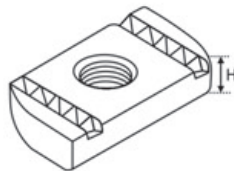
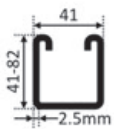

Part No.	Size Thread x Height (mm)	Part No.	Size Thread x Height (inch)
A 001	M6 x 6	A 101	1/2 x 1/4
A 002	M8 x 6	A 102	5/16 x 5/16
A 003	M10 x 8	A 103	5/16 x 3/8
A 004	M12 x 8	A 104	3/8 x 3/8
A 005	M12 x 10	A 105	1/2 x 3/8
A 006	M16 x 12	A 106	1/2 x 1/2
		A 107	5/8 to 7/8 x 3/8
		A 108	5/8 to 7/8 x 7/16
		A 109	5/8 to 7/8 x 1/2

## SHORT | CONICAL spring CHANNEL nuts

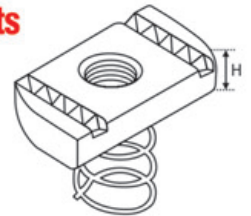
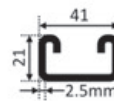

Part No.	Size Thread x Height (mm)	Part No.	Size Thread x Height (inch)
A 021	M6 x 6	A 121	1/4 x 1/4
A 022	M8 x 6	A 122	5/16 x 5/16
A 023	M10 x 8	A 123	5/16 x 3/8
A 024	M12 x 8	A 124	3/8 x 3/8
A 025	M12 x 10	A 125	1/2 x 1/2
		A 126	1/2 x 3/8

## LONG spring CHANNEL nuts

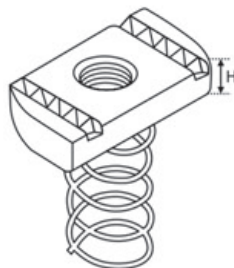
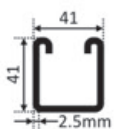

Part No.	Size Thread x Height (mm)	Part No.	Size Thread x Height (inch)
A 041	M6 x 6	A 141	1/4 x 1/4
A 042	M8 x 6	A 142	5/16 x 5/16
A 043	M10 x 8	A 143	5/16 x 3/8
A 044	M12 x 8	A 144	3/8 x 3/8
A 045	M12 x 10	A 145	1/2 x 1/2
		A 146	5/8 to 7/8 x 3/8
		A 147	5/8 to 7/8 x 7/16
		A 148	5/8 to 7/8 x 1/2
		A 149	1/2 x 3/8

## TOP GRIP spring CHANNEL nuts

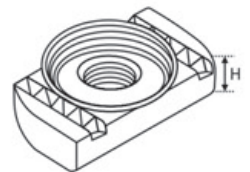
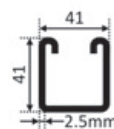

Part No.	Size Thread x Height (mm)	Part No.	Size Thread x Height (inch)
A 061	M6 x 6	A 161	1/4 x 1/4
A 062	M8 x 6	A 162	5/16 x 5/16
A 063	M10 x 8	A 163	5/16 x 3/8
A 064	M12 x 8	A 164	3/8 x 3/8
A 065	M12 x 10	A 165	1/2 x 1/2
		A 166	1/2 x 3/8

## EASY FIT channel NUTS

CAP Design Patent

EU No. 002384362-0001 & Indian No. 251822

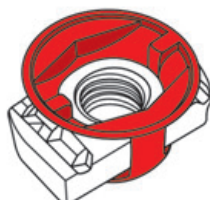
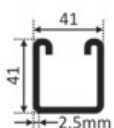

Part No.	Size Thread x Height (mm)	Part No.	Size Thread x Height (inch)
A 081	M6 x 6	A 181	1/4 x 1/4
A 082	M8 x 6	A 182	5/16 x 3/8
A 083	M10 x 8	A 183	3/8 x 3/8
A 084	M12 x 10	A 184	1/2 x 3/8



# channel FITTINGS

flat plate FITTING | A-501

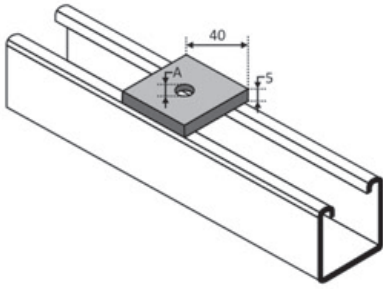

flat plate FITTING | A-502

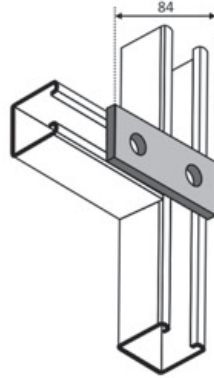

flat plate FITTING | A-503

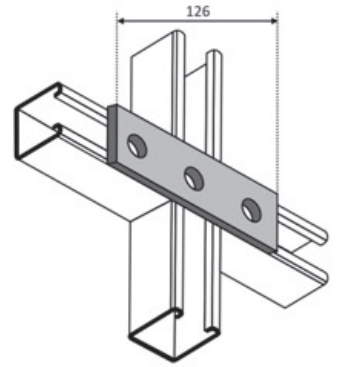

flat plate FITTING | A-504

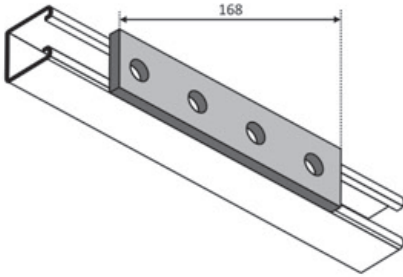

flat plate FITTING | A-505

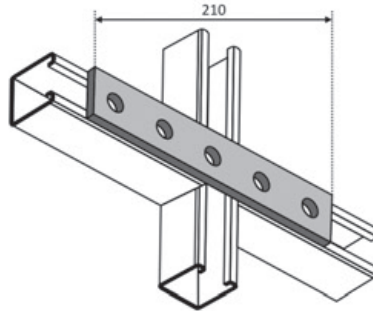

flat plate FITTING | A-518

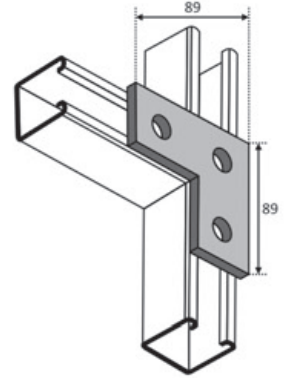

flat plate FITTING | A-519

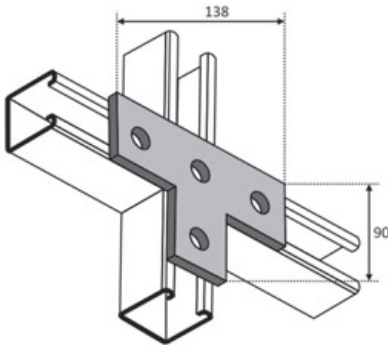

CROSS FITTING | A-532

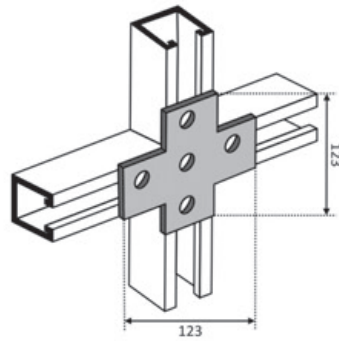

2 lug wing FITTING | A-544

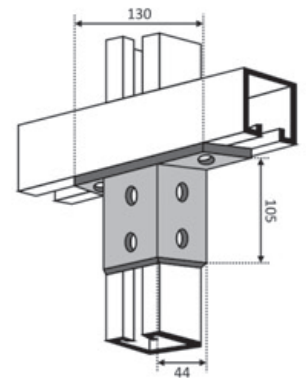

angle FITTING | A-512

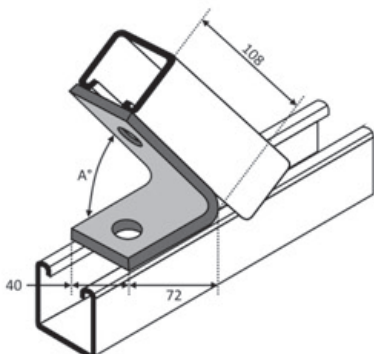

angle FITTING | A-511

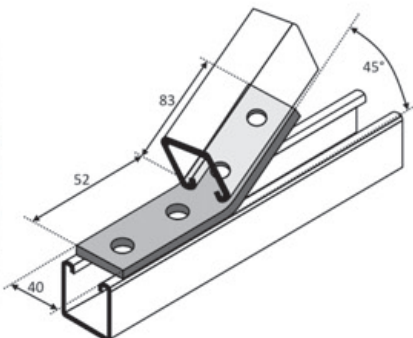

angle FITTING | A-523

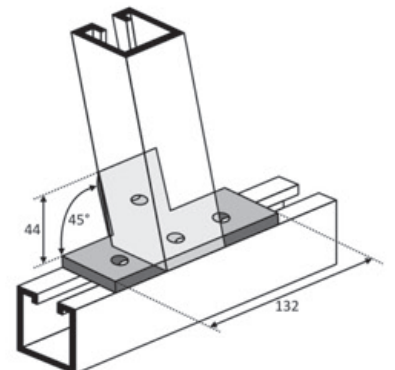

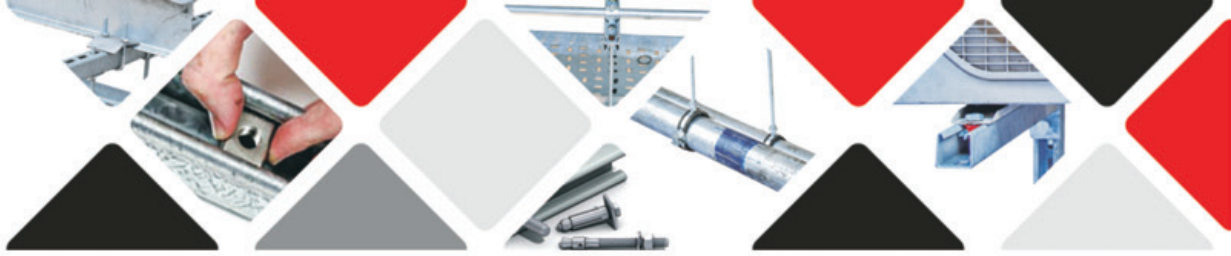

# channel FITTINGS

angle FITTING 90° | A-507

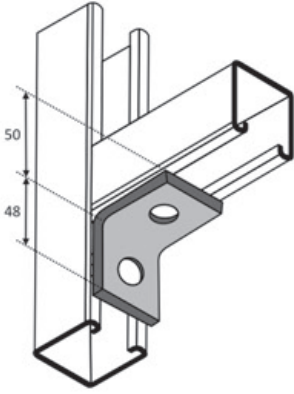

angle FITTING 90° | A-522

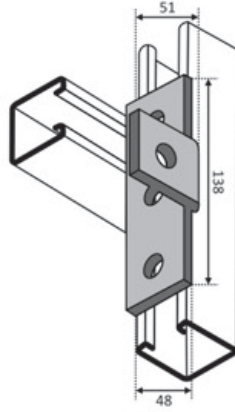

angle FITTING 90° | A-506

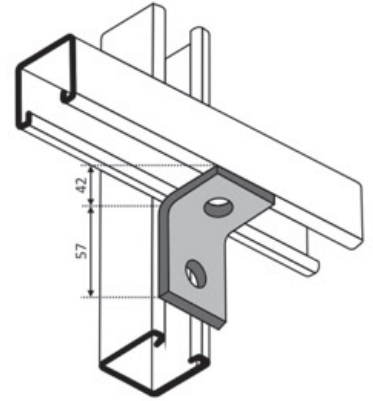

angle FITTING 90° | A-539

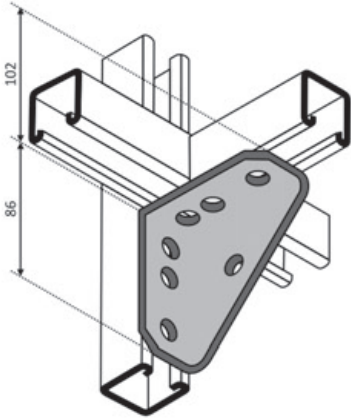

angle FITTING 90° | A-549

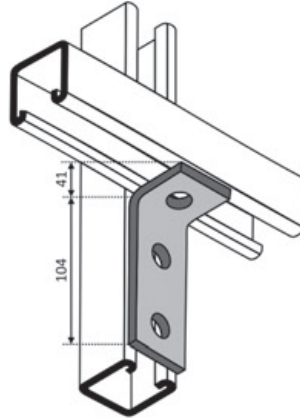

angle FITTING 90° | A-525

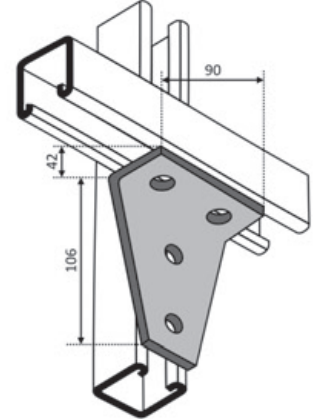

angle FITTING 90° | A-509

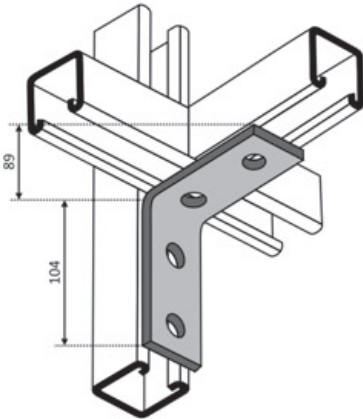

angle FITTING 90° | A-508

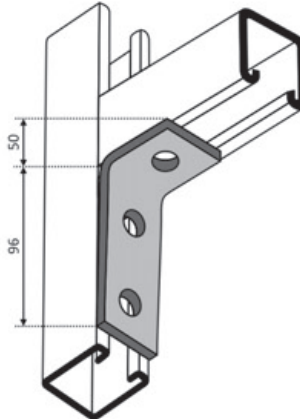

angle FITTING 90° | A-521

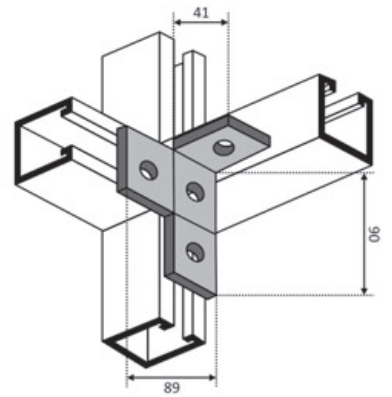

angle FITTING 90° | A-525

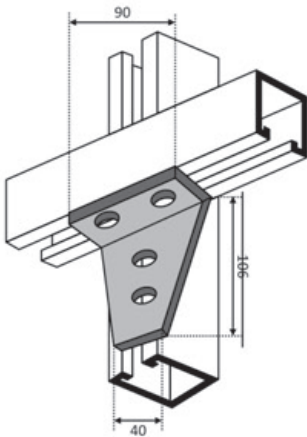

angle FITTING 90° | A-520

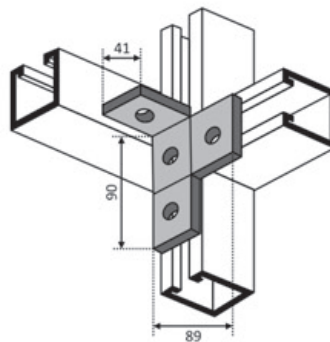

angle FITTING 90° | A-524

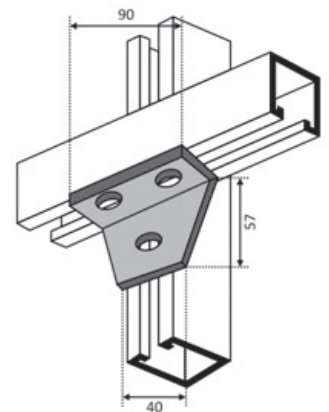



# channel FITTINGS

channel base FITTING | A-538

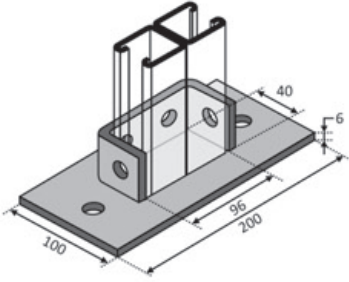

channel base FITTING | A-550

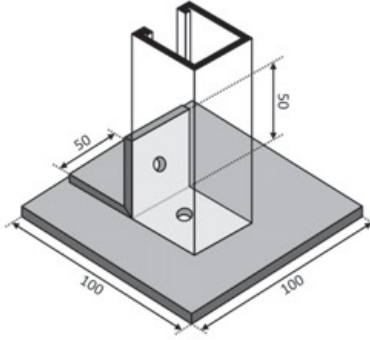

channel base FITTING | A-537

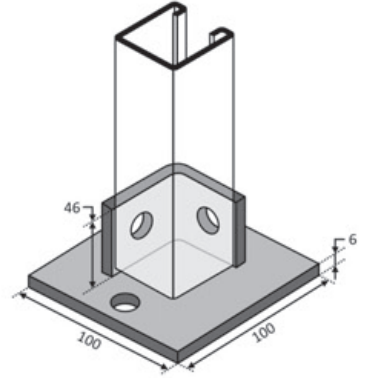

channel BASE fitting 41mm  
PB41mm

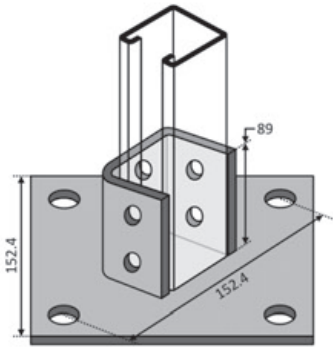

channel BASE fitting 82mm  
PB82mm

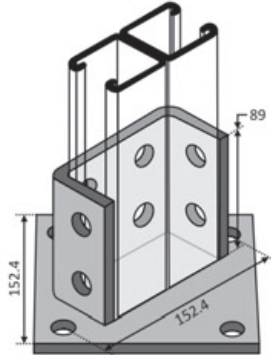

u FITTING & channel COUPLER  
A-534

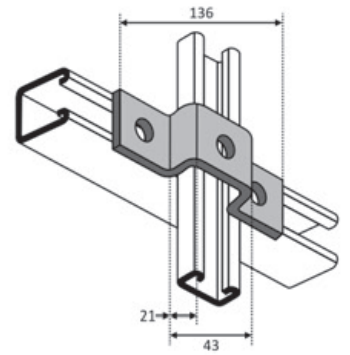

u FITTING & channel COUPLER  
A-535

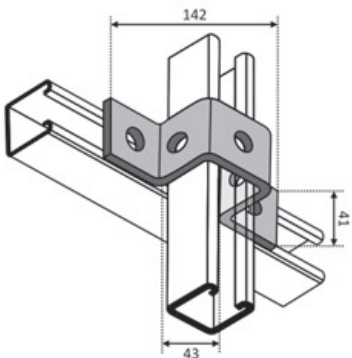

u FITTING & channel COUPLER  
A-536

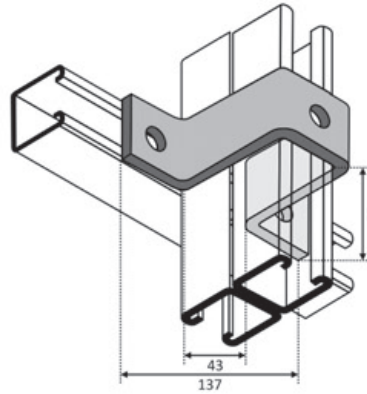

u FITTING & channel COUPLER  
A-533

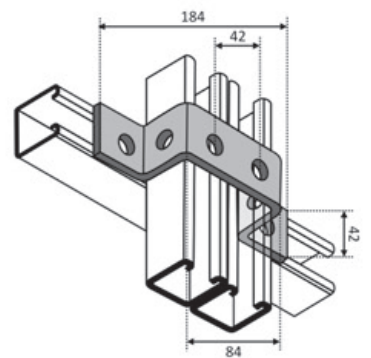

u & z FITTING & channel COUPLER  
A-517

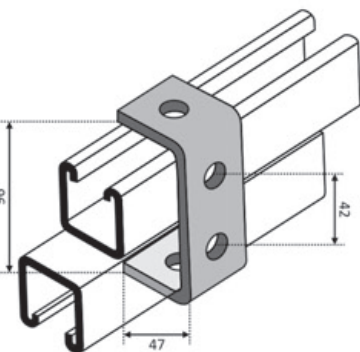

internal COUPLER 41mm  
IC-41m

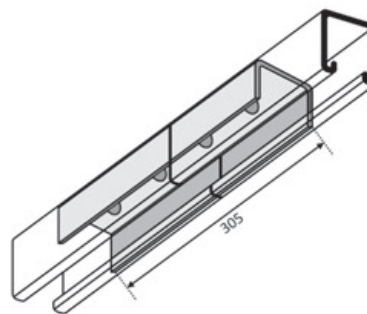

internal COUPLER 21mm  
IC-21mm

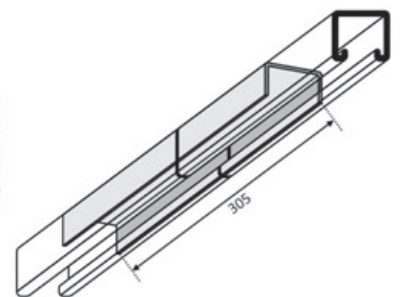



# channel FITTINGS

**Z FITTING | A-526**

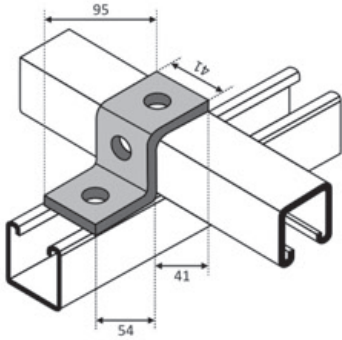

**Z FITTING | A-533**

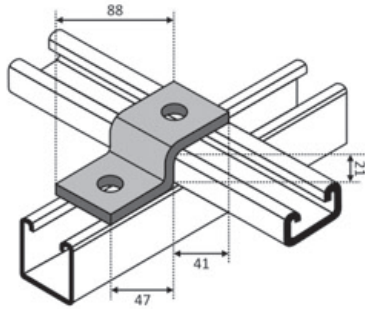

**Z FITTING | A-528**

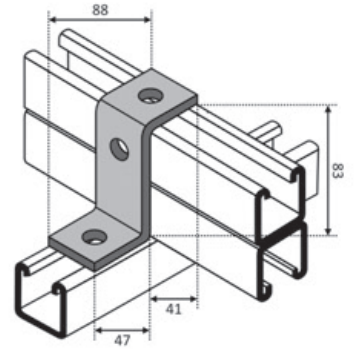

**external COUPLER 21mm | A-530**

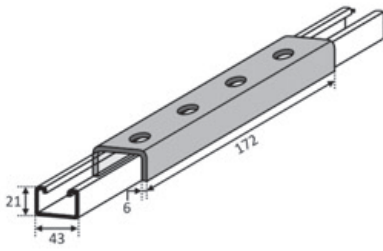

**external COUPLER 41mm | A-531**

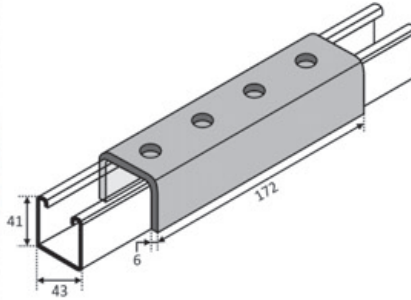

**beam CLAMP | A-543**

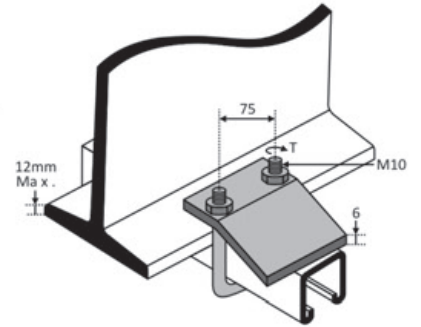

**beam CLAMP | A-529**

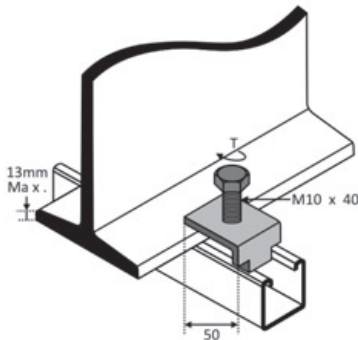

**beam CLAMP | A-547**

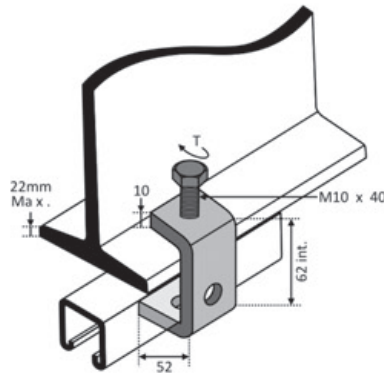

**beam CLAMP | A-546**

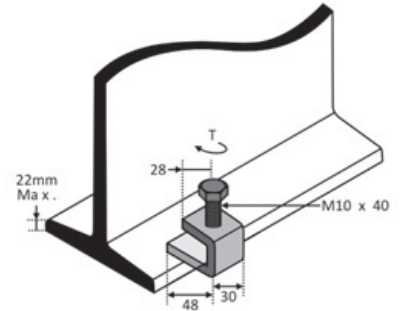

**beam CLAMP | A-542**

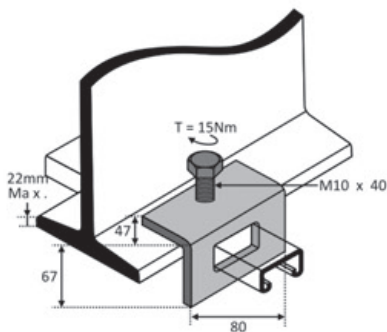

**beam CLAMP | A-541**

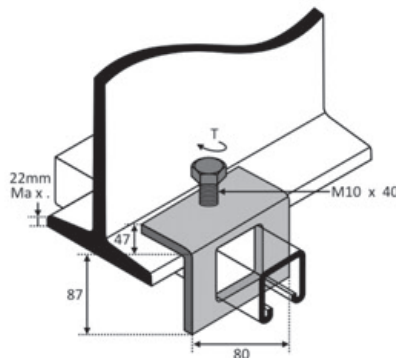

**beam CLAMP | A-545**

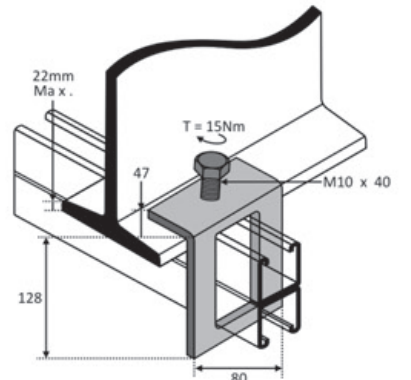



# channel FITTINGS

single CHANNEL gusset BRACKET  
A-549

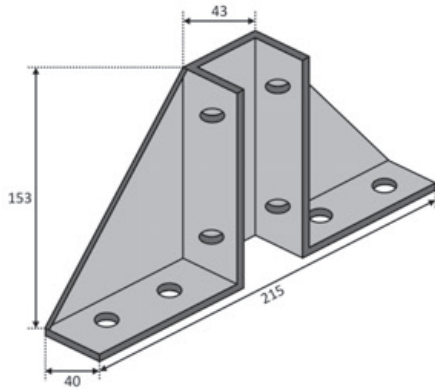

double CHANNEL gusset BRACKET  
A-550

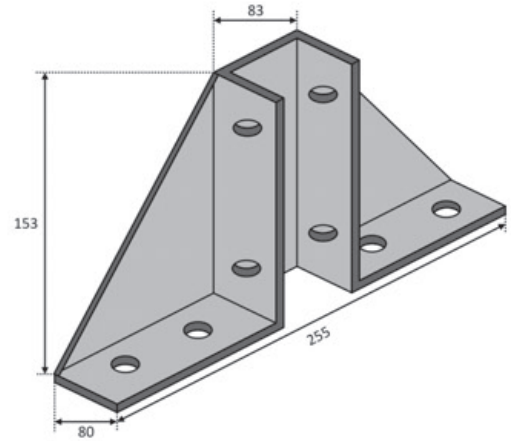

single CHANNEL cantilever ARMS

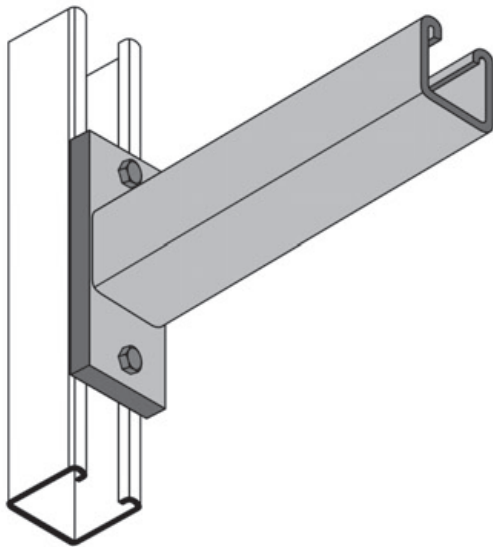

double CHANNEL cantilever ARMS

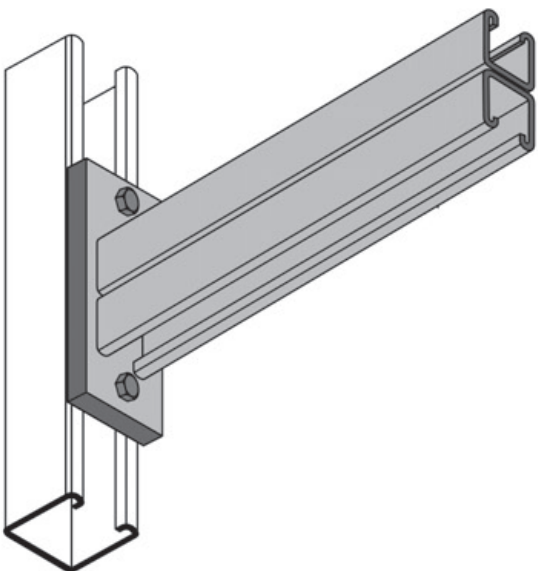

slotted CHANNEL cantilever ARMS

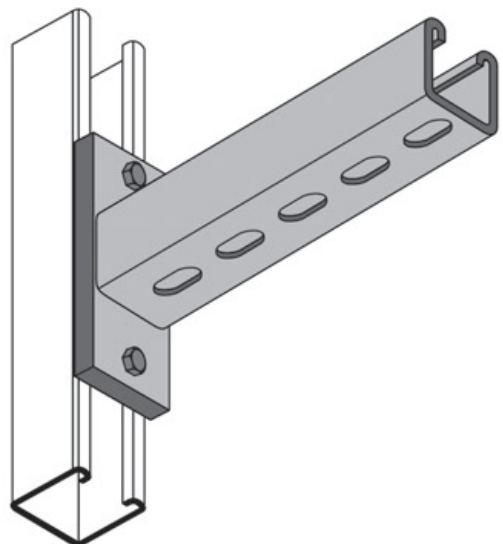

Part No.	Dimension of Channel Length x Width x Height x Thickness	Finish	Material
A-1001	150 x 41 x 41 x 2.5mm	Hot Dip Galvanized	Mild Steel
A-1002	300 x 41 x 41 x 2.5mm		
A-1003	450 x 41 x 41 x 2.5mm		
A-1004	600 x 41 x 41 x 2.5mm		
A-1005	750 x 41 x 41 x 2.5mm		
A-1006	6 x 1 $\frac{5}{8}$ x 1 $\frac{5}{8}$ " x 12g	Bright Zinc Plated	
A-1007	12 x 1 $\frac{5}{8}$ x 1 $\frac{5}{8}$ " x 12g		
A-1008	18 x 1 $\frac{5}{8}$ x 1 $\frac{5}{8}$ " x 12g		
A-1009	24 x 1 $\frac{5}{8}$ x 1 $\frac{5}{8}$ " x 12g		
A-1010	30 x 1 $\frac{5}{8}$ x 1 $\frac{5}{8}$ " x 12g		



# pipe CLAMPS

unlined | rubber lined PIPE clamps

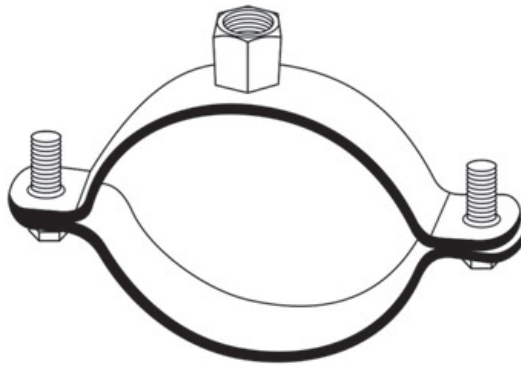
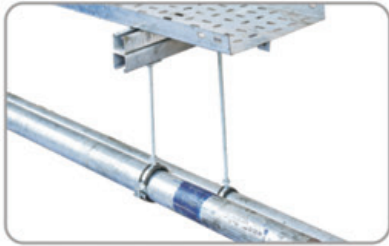

Unlined Pipe Clamp

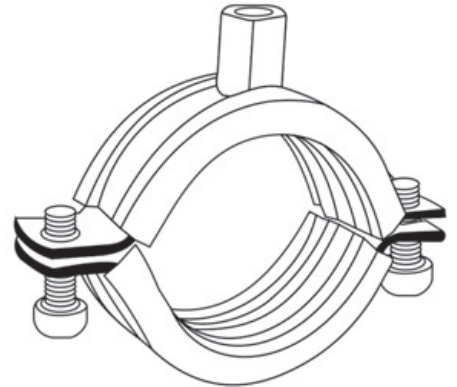

Rubber lined Pipe Clamp

Size	Clip Ø (mm)	Size	Clip Ø (mm)	Size	Clip Ø (mm)	Size	Clip Ø (mm)
5/16"	12-15	54mm	53-58	90-96mm	90-96	142-159mm	142-159
3/8"	15-19	2"	60-64	3½"	96-102	6"	159-166
1/2"	20-25	64-67mm	64-67	110mm	107-112	165-188mm	165-188
3/4"	26-30	70mm	67-72	4"	113-118	8"	188-205
1"	32-36	2½"	75-80	118-126mm	118-126	-	-
1¼"	47-51	80-87mm	80-87	126-138mm	126-138	-	-
1½"	47-51	3"	87-92	5"	138-142	-	-

## channel PIPE clamps

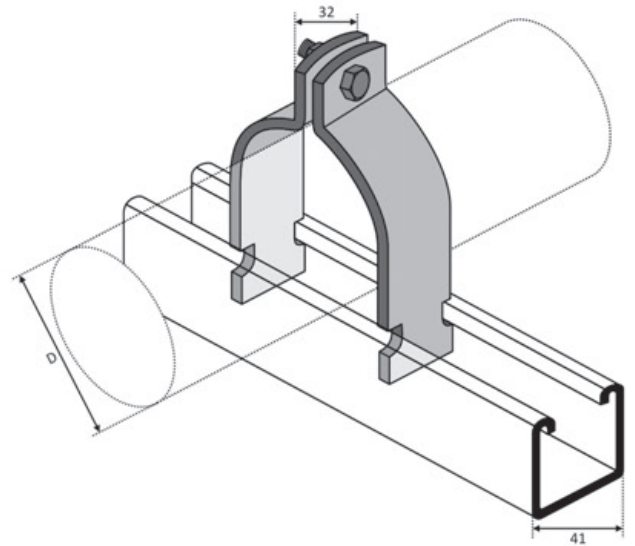
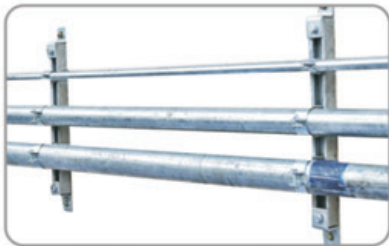

Part No.	D (mm)	Part No.	D (mm)	Part No.	D (mm)	Part No.	D (mm)
1101	8.7 - 10.3	1113	31.8 - 35.9	1125	82.6 - 88.1	1137	182.6 - 190.5
1102	10.3 - 12.7	1114	34.9 - 39.7	1126	88.1 - 95.2	1138	190.5 - 203.2
1103	11.9 - 13.5	1115	39.7 - 42.9	1127	95.2 - 100.0	1139	203.2 - 212.7
1104	13.5 - 14.3	1116	42.0 - 46.8	1128	100.0 - 106.4	1140	212.7 - 225.4
1105	14.3 - 16.7	1117	46.8 - 50.8	1129	106.4 - 111.1	1141	225.4 - 238.1
1106	15.9 - 18.3	1118	48.4 - 52.4	1130	111.1 - 120.7	1142	238.1 - 250.8
1107	18.3 - 20.6	1119	52.4 - 58.7	1131	120.7 - 129.4	1143	250.8 - 263.5
1108	19.0 - 21.4	1120	58.7 - 63.5	1132	129.4 - 138.1	1144	263.5 - 276.2
1109	21.4 - 25.4	1121	63.5 - 68.3	1133	138.1 - 149.2	1145	276.2 - 288.9
1110	25.4 - 27.8	1122	68.3 - 73.0	1134	149.2 - 161.9	1146	288.9 - 301.6
1111	27.0 - 30.2	1123	73.0 - 79.4	1135	161.9 - 174.6	1147	301.6 - 314.3
1112	30.2 - 33.8	1124	76.2 - 82.6	1136	174.6 - 182.6	1148	314.3 - 327.0

Inch Series also Available



## mounting STRUCTURES

mounting STRUCTURE for SOLAR modules



airconditioner OUTDOOR unit MOUNTING bracket



## special FASTENERS

threaded RODS

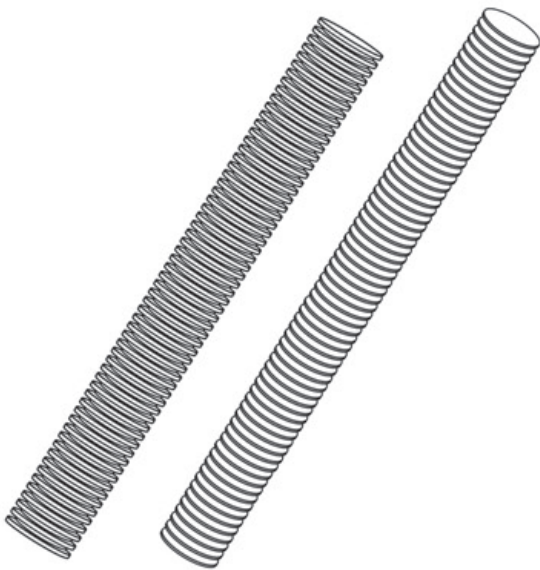

Dia	Length
M6 - M20	1 - 3m
¼ - ¾"	10'

Customized Lengths also Available on Demand

foundation | anchor BOLTS

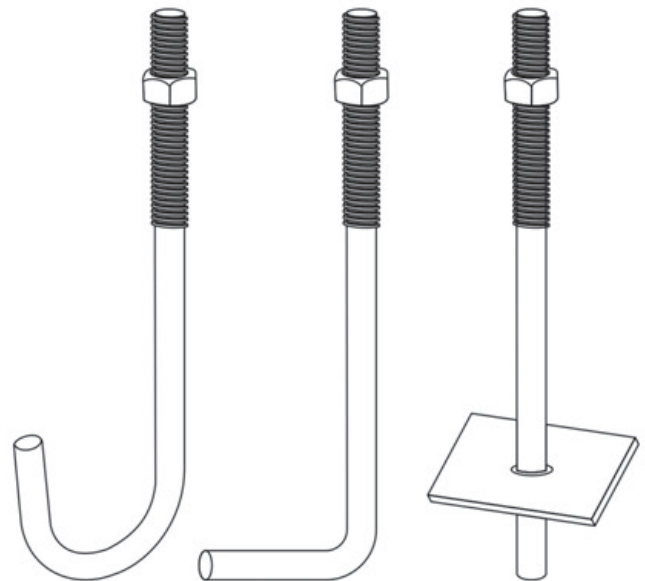

Dia	Length	Bend Type
M12 - M76	200 - 2000mm	J Type
1/2" - 3"	10 - 80"	L Type
24mm	2000mm	Eye Type

Customized Sizes also Available on Demand





## special FASTENERS

### zebra TYPE anchor FASTENER

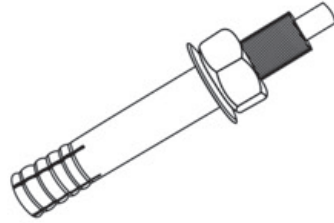

Size x Length	Size x Length	Size x Length
8 x 50mm	12 x 100mm	16 x 200mm
8 x 70mm	12 x 125mm	20 x 75mm
10 x 50mm	12 x 150mm	20 x 100mm
10 x 75mm	16 x 75mm	20 x 125mm
10 x 100mm	16 x 100mm	20 x 150mm
10 x 125mm	16 x 125mm	-
12 x 75mm	16 x 150mm	-

### rawl TYPE anchor FASTENER

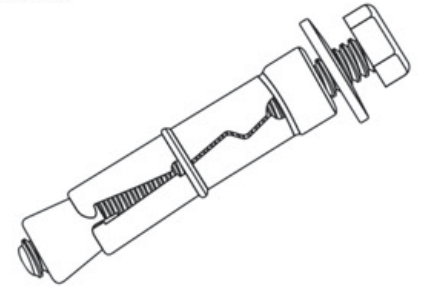

Size x Length	Size x Length	Size x Length
<b>With BOLT</b>	<b>With J &amp; T HOOKS</b>	<b>With PROJECTION BOLT</b>
6 x 50mm	6 x 50mm	6 x 50mm
8 x 60mm	8 x 60mm	8 x 60mm
10 x 75mm	10 x 75mm	10 x 75mm
12 x 90mm	12 x 90mm	12 x 90mm

## special FASTENERS

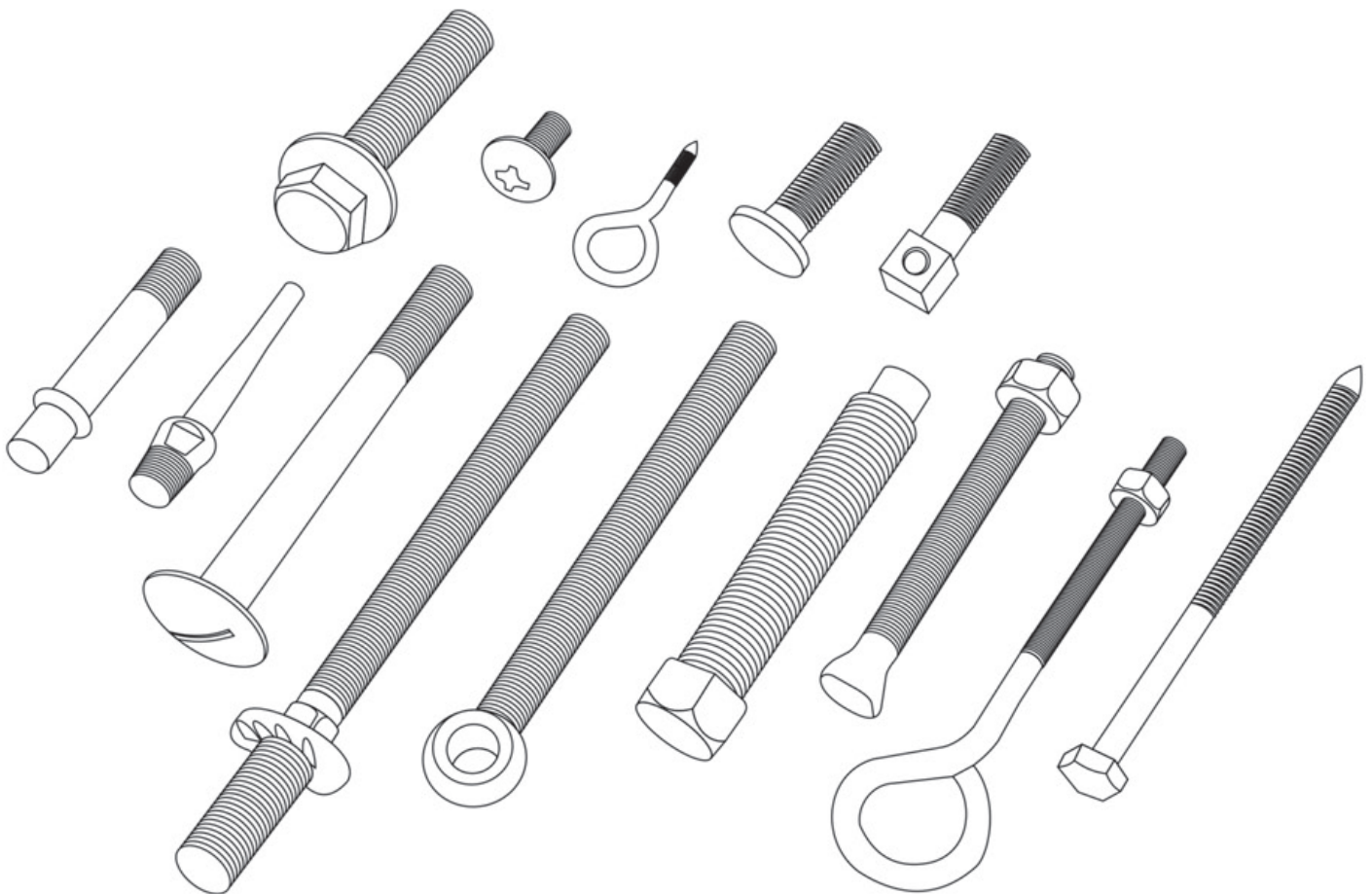



# general ACCESSORIES

hardened **CONE pointed SET SCREWS**

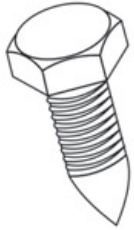

Sizes : M10 x 40mm

purin **CLIP**

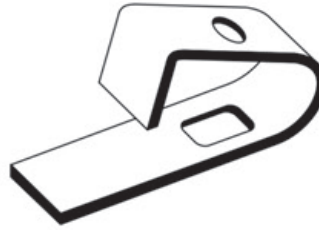

Sizes : M10 - M12

wedge **NUTS**

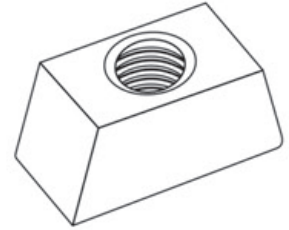

Sizes : M6 - M12

roofing nuts & **BOLTS**

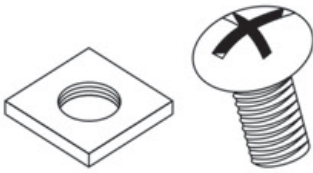

Dia : M6 - M8  
Length : 8 - 80mm

coupling **NUTS**

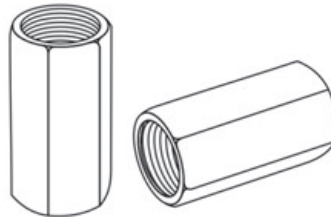

Sizes : M10 - M24

swivel **HANGER**

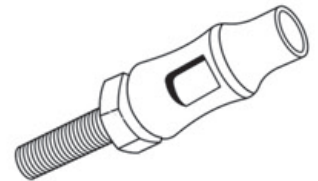

pvc **END CAPS**

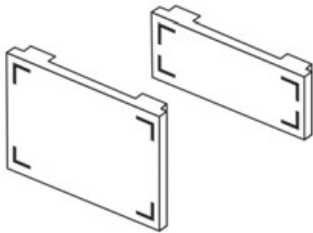

Sizes : 21 & 41mm

hexagon **HEAD sets SCREWS (8.8HT)**

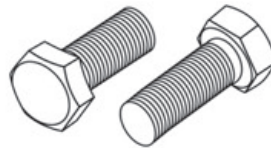

Sizes : M6 - M24

hexagon **NUTS**

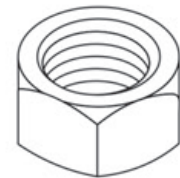

Sizes : M6 - M52

flat **WASHERS**

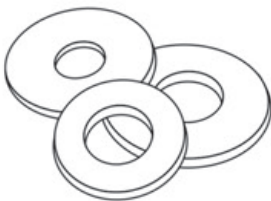

Sizes : M6 - M48

pan **HEAD machine SCREWS**



Sizes : M6 - M12

cablE **TRAY coupler**

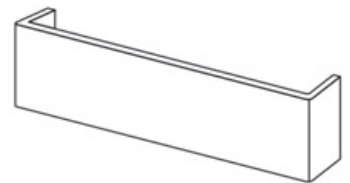

cablE **REEL rods**



button **HEAD BOLTS & NUTS HDG**



casting **G-CLAMP**

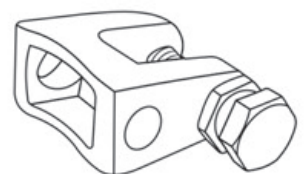

Sizes : M6 - M12

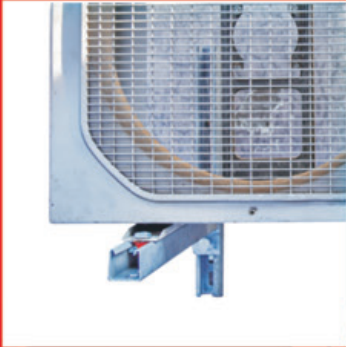

Constructing **STEEL RELATIONS**  
with our **customers**  
all around the world

## **ASHISH INTERNATIONAL**

D-254, Phase-VI, Focal Point, Ludhiana - 141 010 INDIA

Tel : +91 161 2673520 | Mob : +91 99888 60254, +91 99888 54380

Email : 3dstruts@gmail.com, ashishint2001@gmail.com

[www.ashishexports.com](http://www.ashishexports.com)